

CONTACT: ART@EASELOGISTICS.COM

ADDRESS: EASE LOGISTICS  
5725 AVERY RD  
DUBLIN, OH 43016

# CALL FOR ARTISTS

## Request for Proposal

### EASE Building Art Commission Project

**Issued by:** EASE Logistics

**Location:** 6000 Perimeter Dr | Dublin, OH 43016

#### **Contact**

*For questions regarding project scope:*  
art@easelogistics.com

## About EASE

Proudly founded in Dublin, Ohio in 2014, EASE has grown to more than 300 employees, currently occupying three locations in our hometown with additional offices and warehouses in East Liberty and Marysville – and with two new locations under construction.

EASE takes an entirely different approach to logistics where humanity and technology drive. Our focus on continuous improvement elevated us from a small brokerage to a full-service logistics leader. But what hasn't changed is our highly responsive and personalized customer service model.

We know every innovation unlocked, every problem solved, and every second saved can help our customers, carriers, and communities thrive. We're committed to delivering success 24 hours a day, 365 days a year, because we know that getting it right makes all the difference.

## MISSION, VISION, AND VALUES

### Mission

To earn your trust.

### Vision

Create an entirely different logistics experience. Where humanity and technology drive.

### Values

Confidence  
Communication  
Character  
Consistency  
Commitment  
Collaboration

## ABOUT THE PROJECT

EASE seeks to commission an artist and/or artist's team to create site-specific permanent artwork installations in several designated areas of our future headquarters – the new [EASE Building](#) located at 6000 Perimeter Drive, Dublin, Ohio 43016.

EASE was founded and has grown in Dublin, and we know that our success is largely due to the community that has supported us from the beginning. As we grow and accomplish the milestone of our new headquarters, it's important to us that the building serves as a reflection of EASE and our community, and we plan to feature the work of artists who also call Central Ohio home.

Our vision is that these artworks tell the story of EASE and the story of our communities: Dublin, Columbus, and Ohio, and that through these installations, our visitors will learn about our community and be inspired. The commissioned artworks should serve as a nod to EASE and our industry (transportation and logistics) and must align with the look and feel of our new home. The style of artwork and the piece's concept will depend upon the artist's interpretation and the inspiration they draw from the overall brand, mission, and work of EASE.

*"Community impact is one of the most important initiatives for EASE, so we look forward to bringing the community inside our building to decorate the halls, install artwork by local artists and creatively highlight our homegrown roots." said Peter Coratola, Jr., president & CEO at EASE.*

CONTACT: ART@EASELOGISTICS.COM

ADDRESS: EASE LOGISTICS  
5725 AVERY RD  
DUBLIN, OH 43016

# **SCOPE OF WORK**

## *SPECIFICATIONS*

# LEVELS 1-4 STAIR

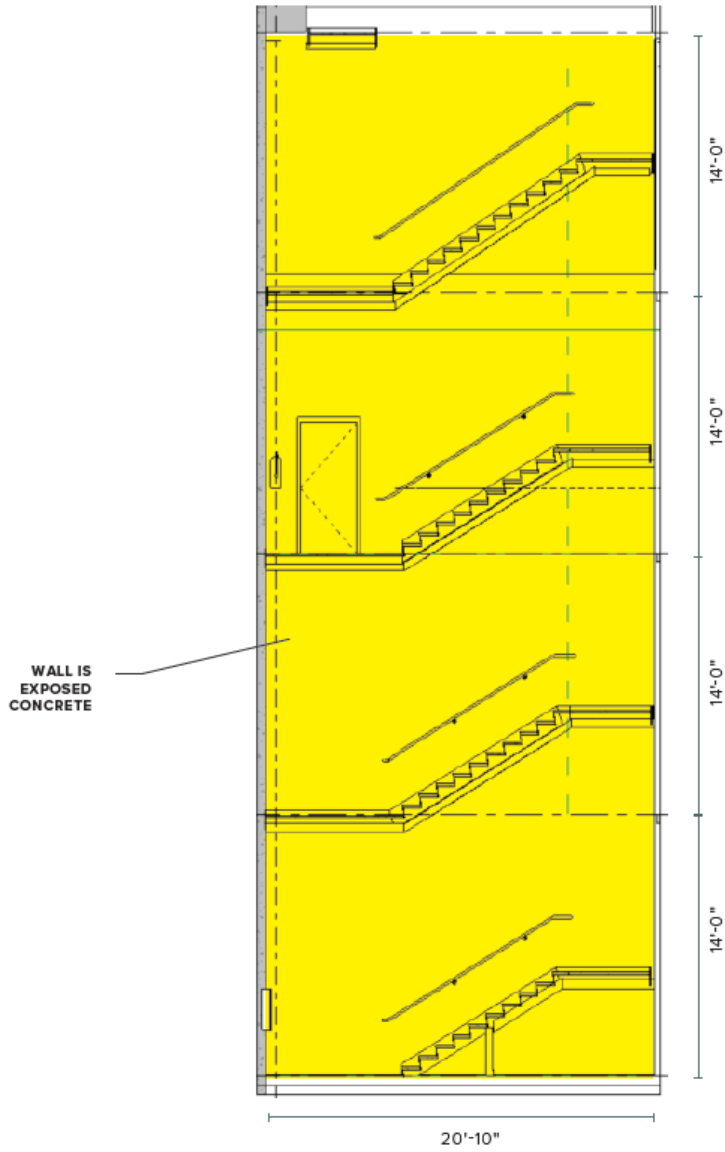

**Scope of Work (continued)**

Specifications:

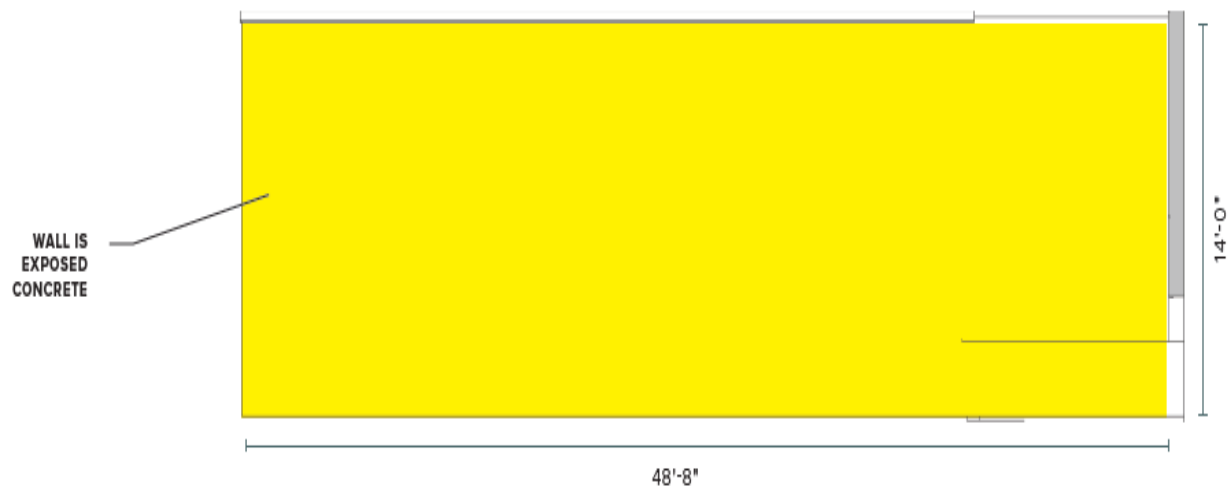
**LEVEL 1 EXTERIOR PATIO**

**PLEASE NOTE:** Installations in this area will not be covered and exposed to harsh weather conditions.

# LEVEL 3 OPEN OFFICE

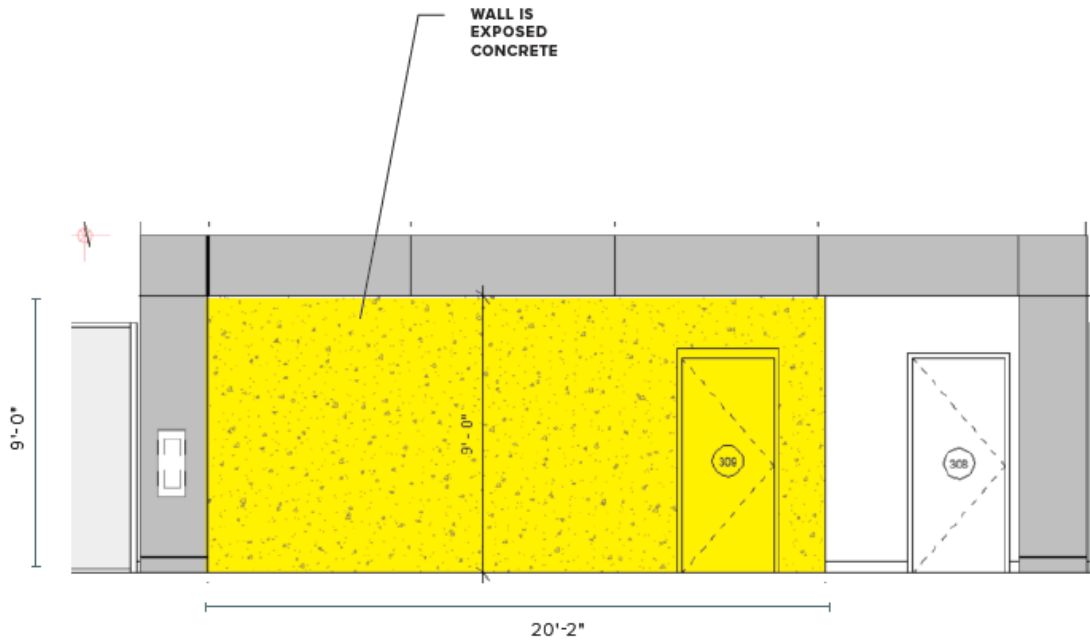

# LEVEL 4 OPEN OFFICE

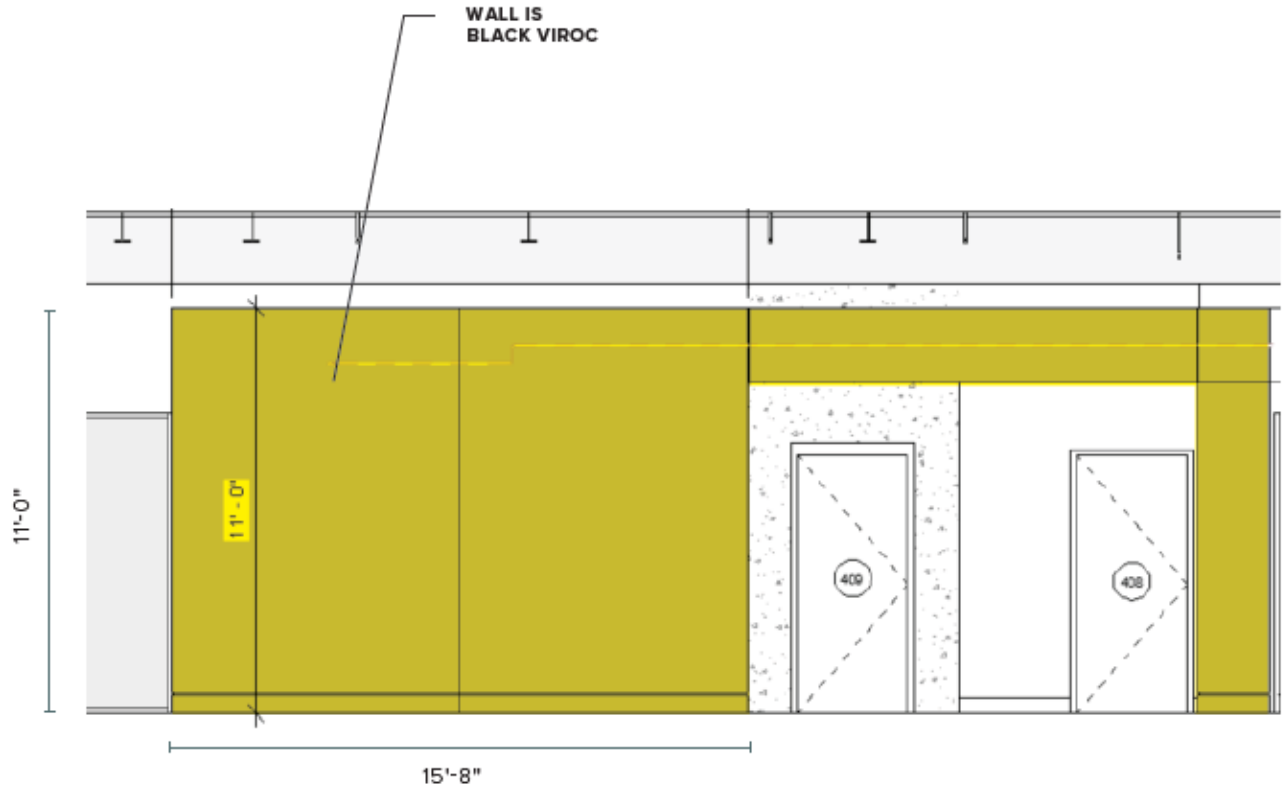



## REQUIREMENTS & CRITERIA

### ARTIST/TEAM NAMES

- EASE believes that collaboration multiplies impact. If the applicant would prefer to collaborate with other artists to complete the artwork(s), please indicate that intention in the proposal.

### EMAIL ADDRESS

### PHONE NUMBER

### ARTIST/TEAM LINKS

- Instagram
- Facebook

### ARTIST PORTFOLIO

### RELEVANT BACKGROUND

- Please outline your relevant art background and areas of focus. Detail your experience with and approach to art and your role in other projects of similar scope. (2000-character limit)

### WHAT IS YOUR INTEREST IN THIS SPECIFIC PROJECT?

- Please describe what you bring to the project as an artist, your sources of inspiration presented by the project, and any other comments that might help differentiate you as a candidate. (2000-character limit)

### CONCEPT SAMPLE(S)

- Please provide a sample or samples of the concept that will help us understand what the final product may look like.

### CONCEPT BID INSTALLATION SITE

### ARTISTS SAMPLES (UP TO 6)

### ANTICIPATED BUDGET

- To include all artists fees, materials, insurance, fabrication, installation, travel, safety equipment, and other project related expenses.
- Up to (3) design reviews.
- The artist is responsible for delivery and placement of the installation.
- The artist is not responsible for maintenance of the installation but is responsible for providing guidelines for proper maintenance.
- Payments will be divided evenly and paid in two installments - 50% at the beginning of the engagement and 50% after install.

### SUBMISSION

- Submit to <https://easelogistics.com/calling-all-local-artists> BY FEBRUARY 16, 2024 AT 11:59:59 P.M. EASTERN DAYLIGHT TIME

#### Contact

For questions regarding project scope:

[art@easelogistics.com](mailto:art@easelogistics.com)

## Selection

Selection of artists will be determined by a committee consisting of EASE team members. The following criteria will guide how the committee selects the artist partner:

A.	<b>Design, Concept Sample</b>
B.	<b>Alignment with EASE Brand</b> <ul style="list-style-type: none"> <li>- <i>How well the submission aligns with EASE's Mission, Vision, &amp; Values.</i></li> <li>- <i>How well the submission represents EASE and its commitment to Dublin and the larger surrounding community.</i></li> <li>- <i>How well the submission aligns with our contributions to the transportation and logistics industry.</i></li> </ul>
C.	<b>Quality, Longevity of Materials, Maintenance Requirements</b>
D.	<b>Experience &amp; Demonstration of Past Work (Portfolio)</b>
E.	<b>Completion &amp; Quality of RFP Submission &amp; Interview</b>

## PROJECT TIMELINE

Process and Timeline		
EASE Issues RFP	December 18, 2023	Formal RFP issued to EASE employees and preferred artists
On-Site Visit	January 17, 4pm - 6pm ET January 22, 4pm - 6pm ET	Site visit.
RFP Final Bids Due	February 16, 2024	Please follow submission guidelines listed in this document.
EASE Internal Review	Week of February 19, 2024	Internal review to be completed.
Artist Interviews	Week of March 4, 2024	In-person at EASE (can arrange virtually if needed).
EASE Tentatively Awards the Work ( <i>pending signed contract</i> ) and Notifies All Artists	Week of March 11, 2024	EASE will provide a written contract upon award of the commission.
EASE + Selected Artist Finalize Contract	Week of March 18, 2024	If contract is not finalized, EASE will select another artist.
Design Concept Finalization	Based on individual contract	Estimated timeline includes opportunity for 3 design reviews.
Target Installation Date*	Based on individual contract. No later than August 30, 2024	Date pending construction timeline, move-in, and the artist's schedule. Will be based on individual contracts.

\*Estimated targets; subject to change

**Disclaimer:**

**Incomplete application materials or artists who do not meet eligibility requirements will not be considered.**

*At the completion of the project, EASE will own and retain all rights to the art installation. The artist may use the images for self-promotion materials only. Nothing contained in this RFP creates nor shall be construed to create any contractual relationship between EASE and the artist. We make no commitment in or by virtue of this RFP to purchase any goods and/or services from any supplier; nor does the receipt of any proposal place EASE under obligation to award an agreement to that or any other artist. Such commitments and binding contractual relationships may be made only in and through a written agreement signed by both parties. The artist's proposals shall constitute an offer which remains valid for a minimum period of 30 days after the proposal submission.*